

2. Components

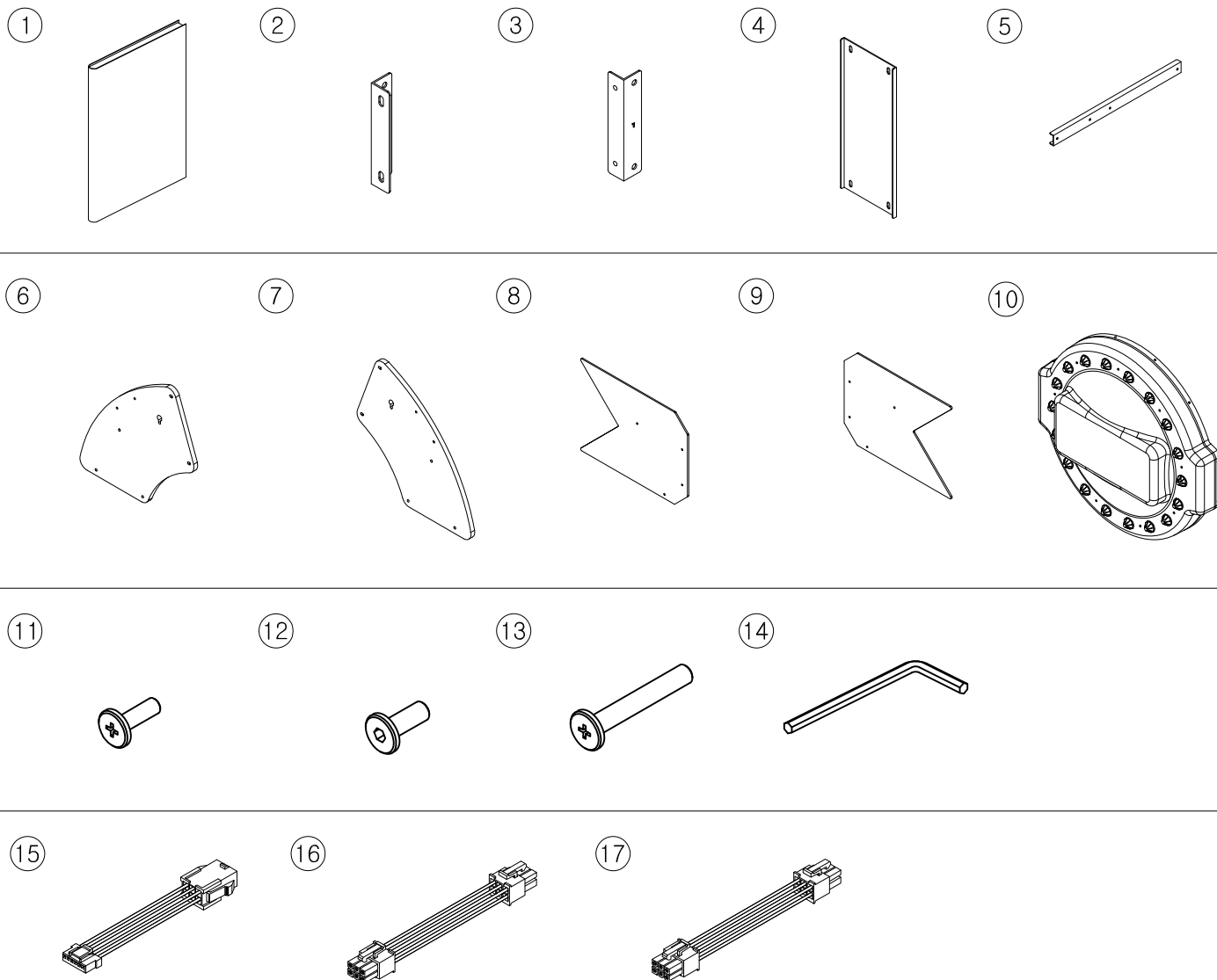

No.	Part Name	Spec.	Quantity	Code No.
1	Power Roll Marquee Billboard Manual	Power Roll	1	MPRM0MAN001
2	TWIN CASE FRONT FIXED BKT-L	SPCC-1.6t	1	MPRM0MET009
3	TWIN CASE FRONT FIXED BKT-R	SPCC-1.6t	1	MPRM0MET008
4	TWIN CASE BACK FIXED BKT	SPCC-2.0t	1	MPRM0MET007
5	MARQUEE SIDE FOMEX FIXED BKT	SPCC-1.6t	2	MPRM0MET005
6	MARQUEE BILLBOARD SIDE PANEL-L	PW-15.0t	1	MPRM0WOO003
7	MARQUEE BILLBOARD SIDE PANEL-R	PW-15.0t	1	MPRM0WOO002
8	MARQUEE BILLBOARD SIDE POP FOMEX-L	FOMEX-5.0t	1	MPRM0A&S002
9	MARQUEE BILLBOARD SIDE POP FOMEX-R	FOMEX-5.0t	1	MPRM0A&S001
10	MEGA MARQUEE BILLBOARD Ass'y	ASSEMBLE	1	APRM0ASM004
11	FLAT HEAD BOLT M5 X 16	M5 X 16L	12	-
12	WRENCH FLAT HEAD BOLT M6 X 16	M6 X 16L	2	-
13	FLAT HEAD BOLT M6 X 40	M6 X 40L	12	-
14	Wrench	4mm	1	MXXX0REN002
15	LINK-A HARNESS (Green)	KMCAN-HAR-207A	2	MPRM0HAR007
16	LINK-B HARNESS (Green)	KMCAN-HAR-208A	1	MPRM0HAR008
17	MAQ BILLBOARD-A HARNESS (Red)	KMCAN-HAR-201A	1	MPRM0HAR001

3. MAIN BOARD DIP SWITCH SETTING

Note!

When you Change the setting of the Master, both Master and Slave machines must be in attraction mode.
(Do not change setting while the machines are being played.)

It takes 5~10 seconds to upload the Master's setting to the Slave machine.

If the Master is set, the Slave's setting will also follow the Master's setting.

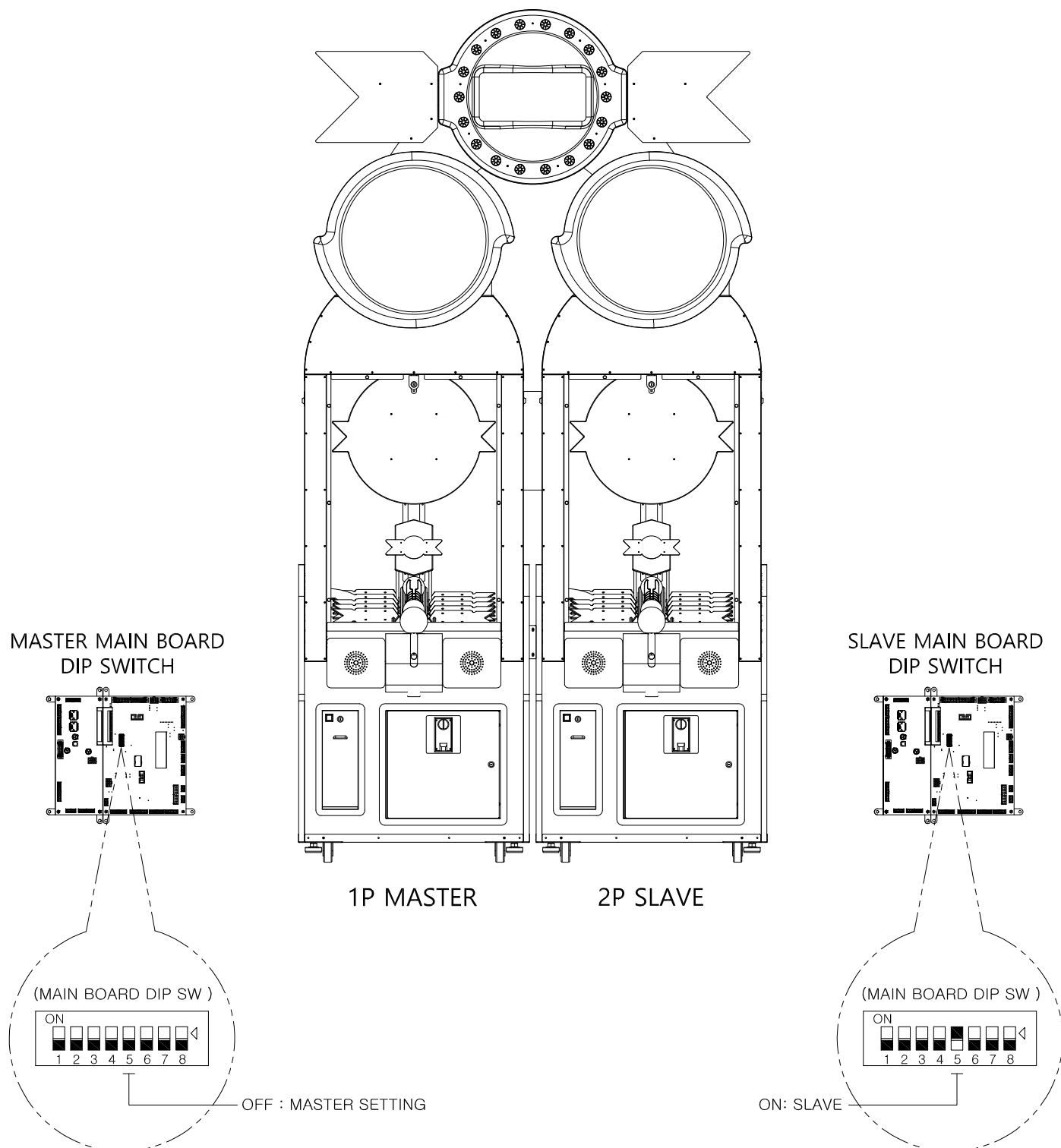

Note!

If the communication is complete, LCD display will show "LK-M" for 1P Master and "LK-S" for 2P SLAVE.

(LCD Display Board)

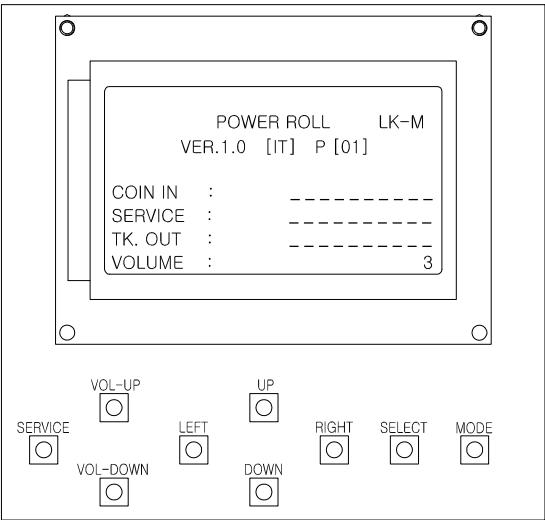

(1P Master)

(LCD Display Board)

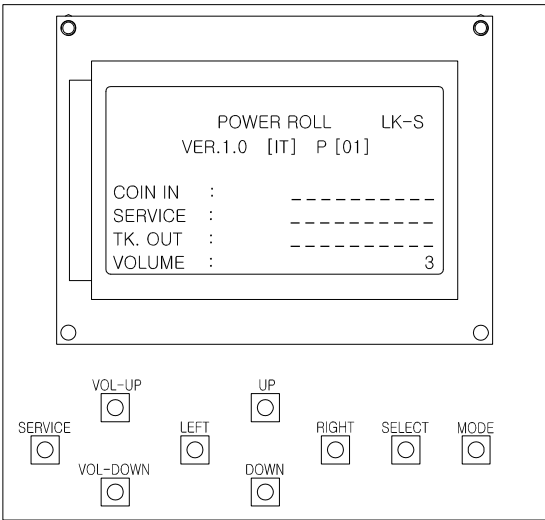

(2P Slave)

4. How to Assemble

Step1.

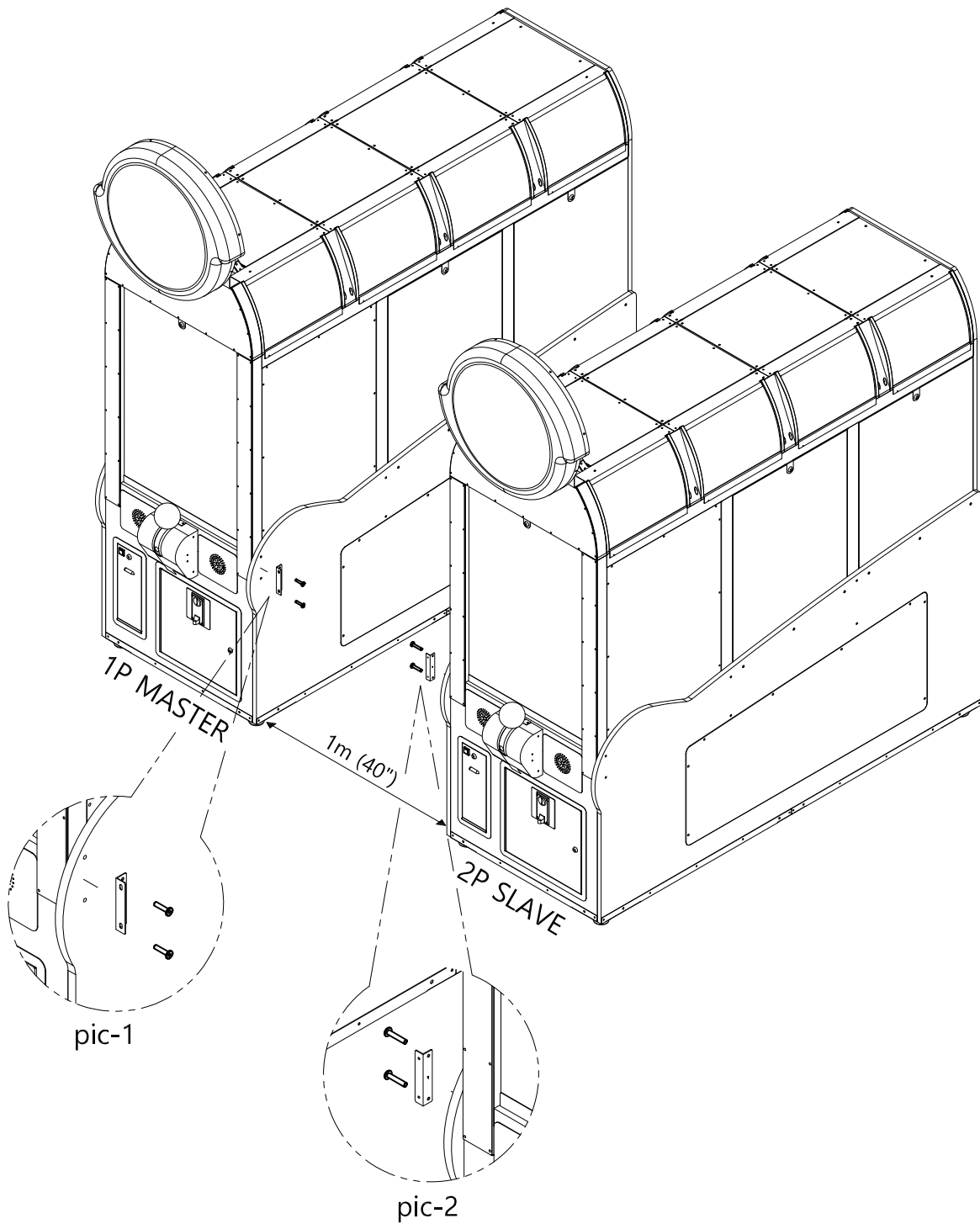

1. As shown at the drawing above, place 1P MASTER to the left and 2P SLAVE to the right.
To be easy to assemble them, leave 1m (40inch) space between 1P Master and 2P Slave.
2. (Refer to pic-1) Unscrew the bolts using a 4mm wrench. Assemble 'Twin Case Front Fixed Bracket L' here.
3. (Refer to pic-2) Unscrew the bolts using a 4mm wrench. Assemble 'Twin Case Front Fixed Bracket R' here.

Step2.

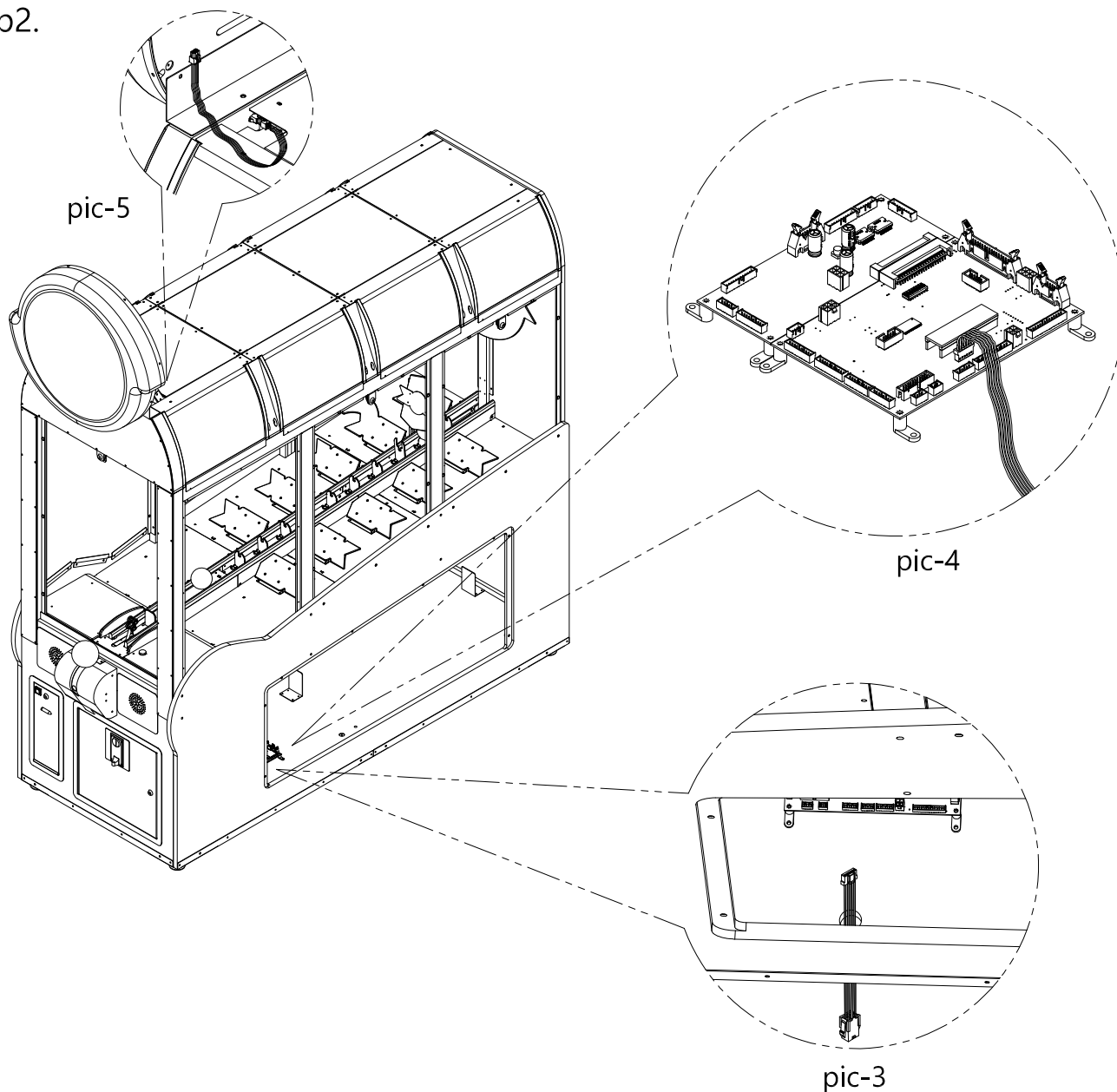

4. [1P MASTER] Open the Main Cabinet Side Door.
(Refer to pic-3) Insert the Link-A Harness (Green) into the hole in the floor as shown.
(Refer to pic-4) Connect the Link-A Harness (Green) to the 3rd slot on the mainboard.
5. [2P SLAVE] Open the Main Cabinet Side Door.
(Refer to pic-3) Insert the Link-A Harness (Green) into the hole in the floor as shown.
(Refer to pic-4) Connect the Link-A Harness (Green) to the 3rd slot on the mainboard.
6. [2P SLAVE] Set DIP Switch of 2P slave Main Board as shown below. (Refer to PAGE 4 too.)

(MAIN BOARD DIP SW)

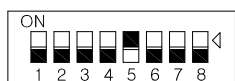

ON: SLAVE

7. Close the Main Cabinet Side Doors.
8. (Refer to pic-5) Connect the MAQ Billboard-A harness (connector:RED) to the connector from the 1P Master as shown above pic-5.

Step3.

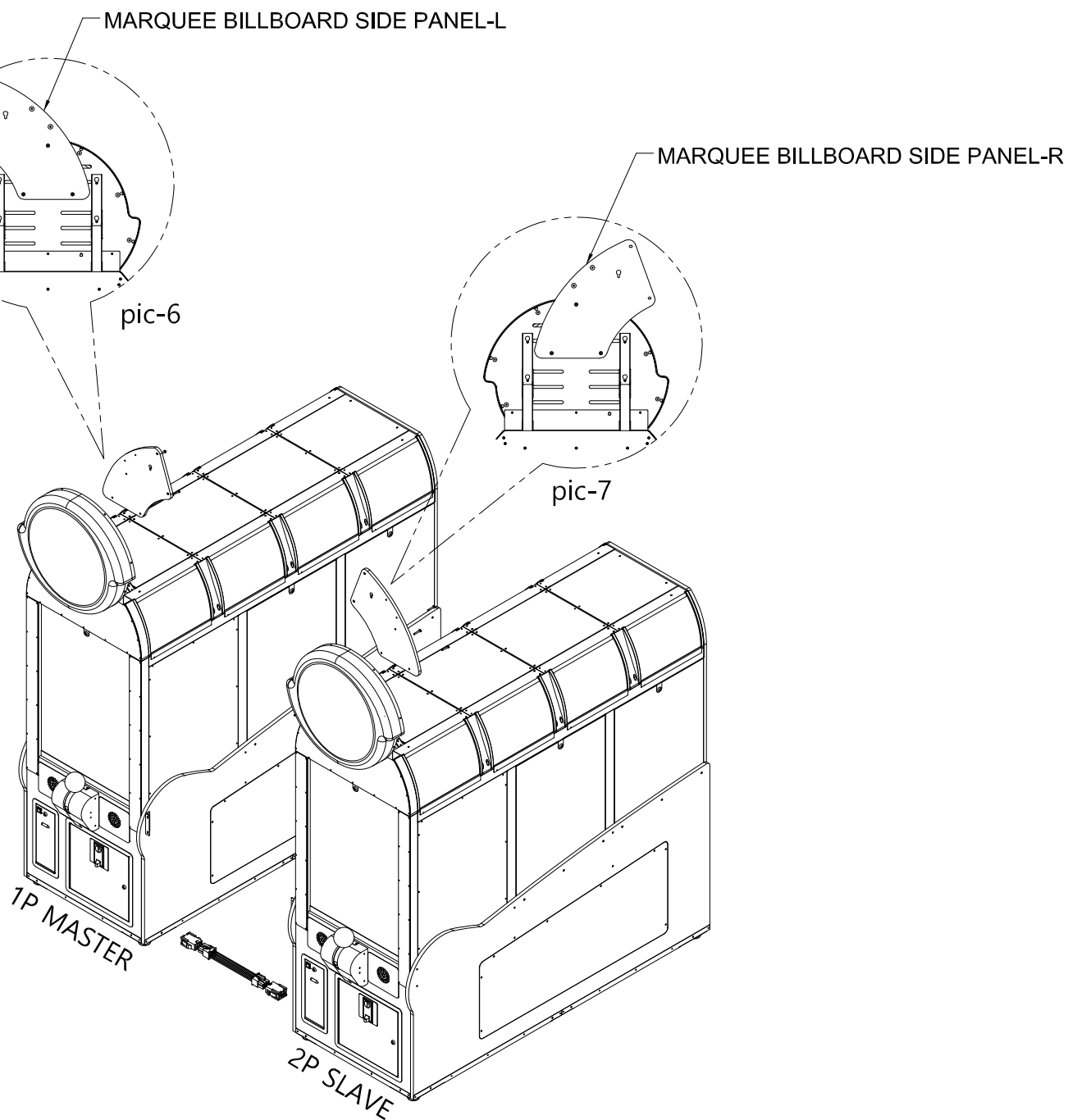

9. With the Link-B Harness(Green), connect the Link-A Harness from 1P main board and the Link-A Harness from 2P Main board.

10. (Refer to pic-6) Install the Marquee Billboard Side Panel-L (Flat Head Bolt M6x40L, 3EA)

11. (Refer to pic-7) Install the Marquee Billboard Side Panel-R (Flat-Head Bolt M6x40L, 3EA)

Step4.

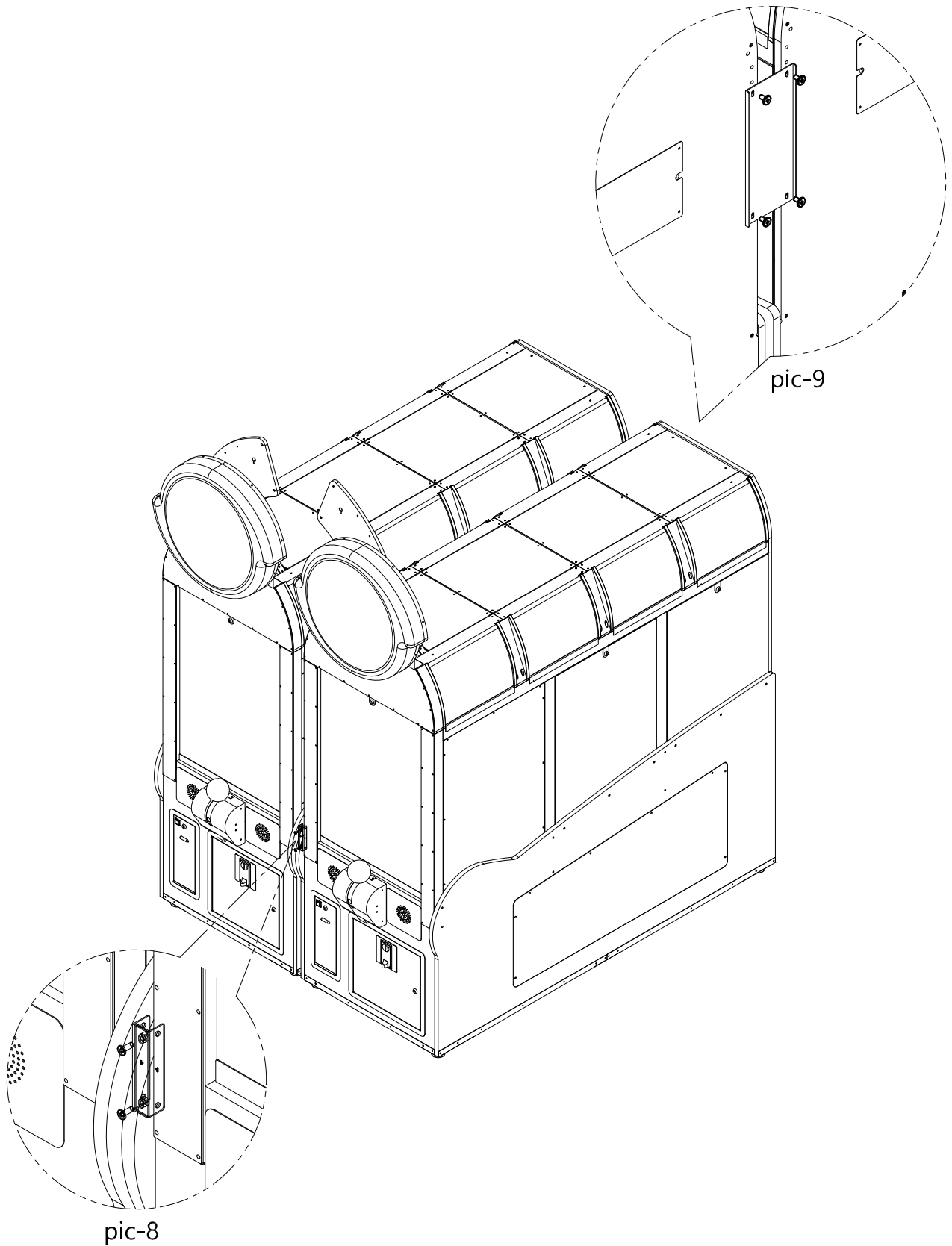

12. Now place 2 cabinets close to each other.
13. (Refer to pic-8) Secure the bodies of 1P Master and 2P Slave to each other using a Wrench Flat Head Bolt (M6x10L, 2EA).
14. (Refer to pic-9) Unscrew the 4 screws at the back side of the cabinets. Secure the two cabinets with the Twin Case Back Fixed Bracket.

Step5.

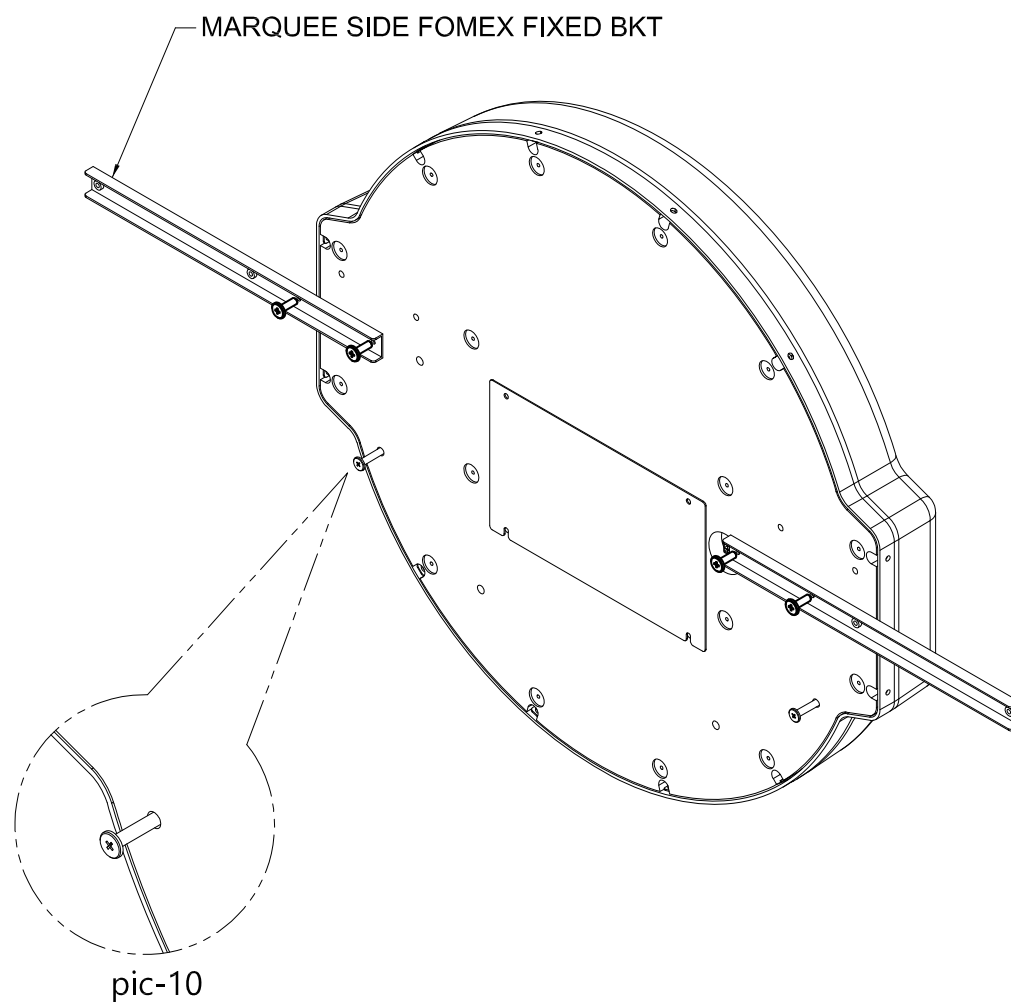

15. Install the Marquee Side Fomex Fixed Bracket to the left and right of the Mega Marquee Billboard Ass'y. (TH Bolt M4x16L, 4EA)
16. (Refer to pic-10) Screw the flat head bolts (M6x40L, 2EA) slightly on the left and right sides of the marquee in order to make it easier when it is mounted in the cabinet.

Step6.

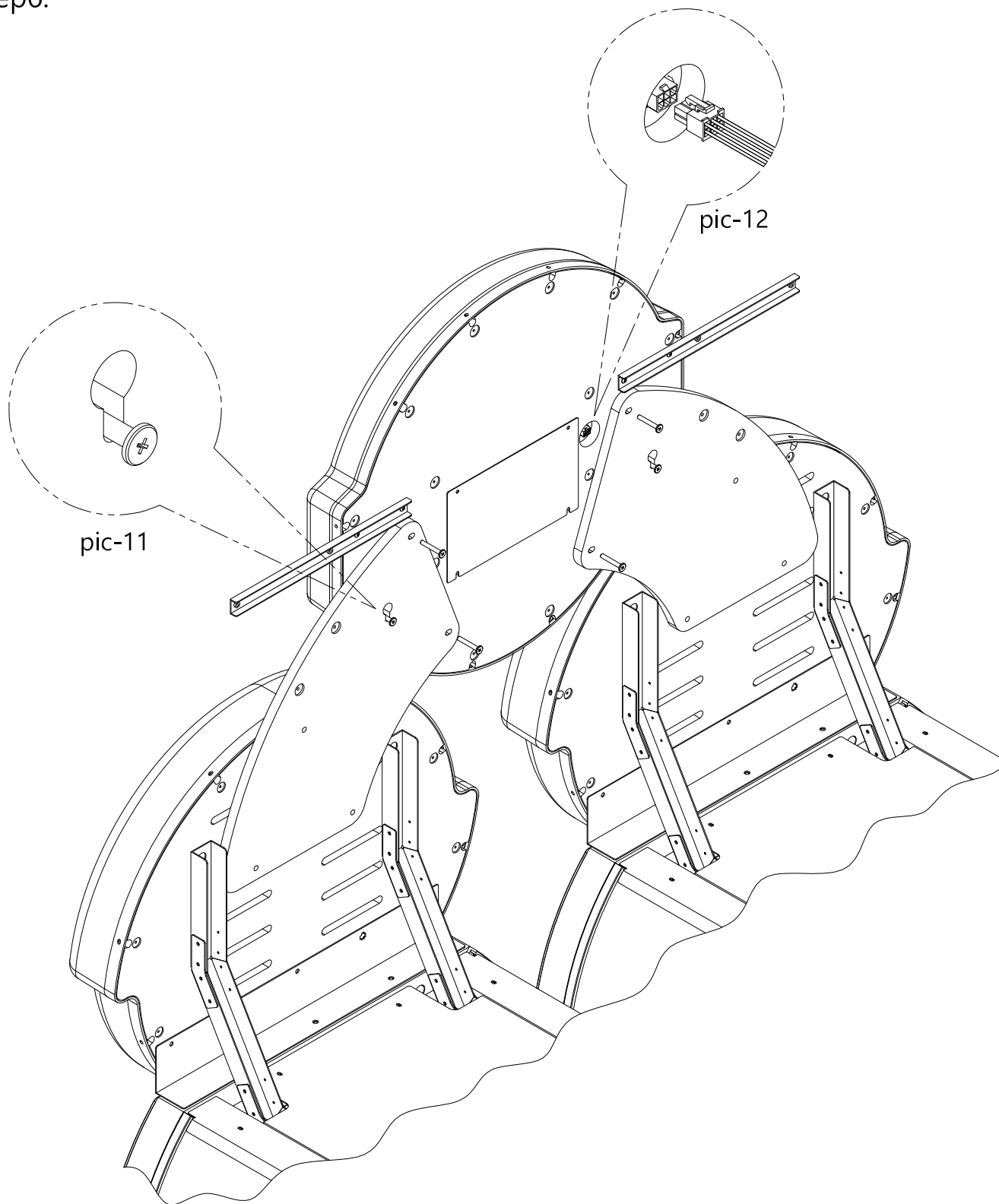

17. Hang up the Mega Marquee Billboard Ass'y which was prepared in STEP 5 as shown at the (Refer to pic-11)
Fix the Mega Marquee Billboard Ass'y to the Mega Marquee Side Panels with the screws
(Flat Head Bolt M6x40L).
Tighten completely the half-fastened screws in the previous step.
18. Connect the MAQ Billboard-A Harness (connector: RED) to the Mega Marquee.

Step7.

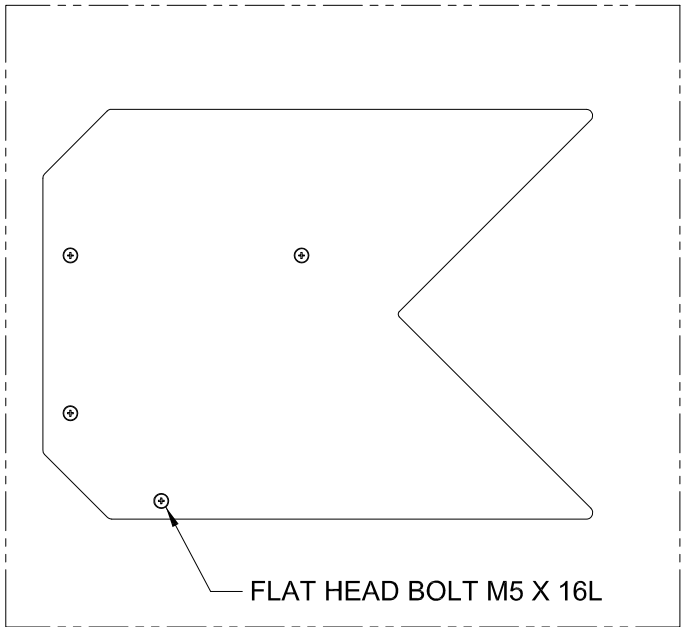
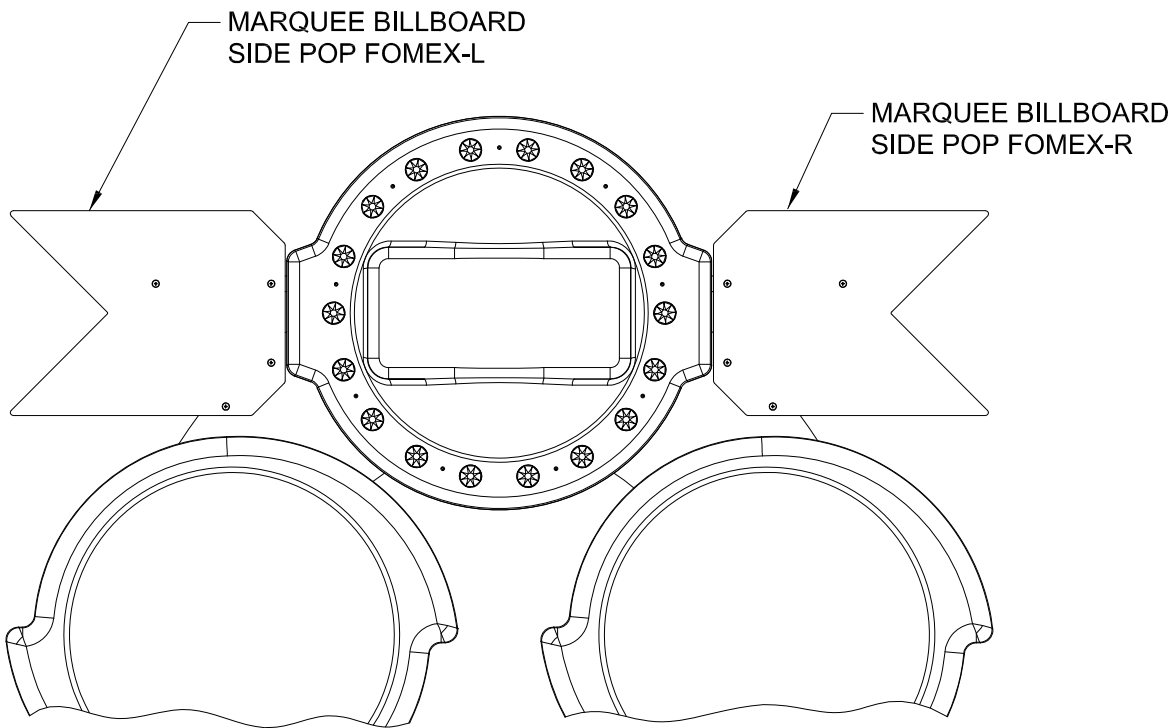

pic-13

19. (Refer to pic-13) Install the Marquee Billboard Side POP Fomex-L, R on both sides of the Mega Marquee as shown above. (Flat Head Bolt M5x16L, 8EA)